

Do as directed:

a) Look at the picture and answer the following:

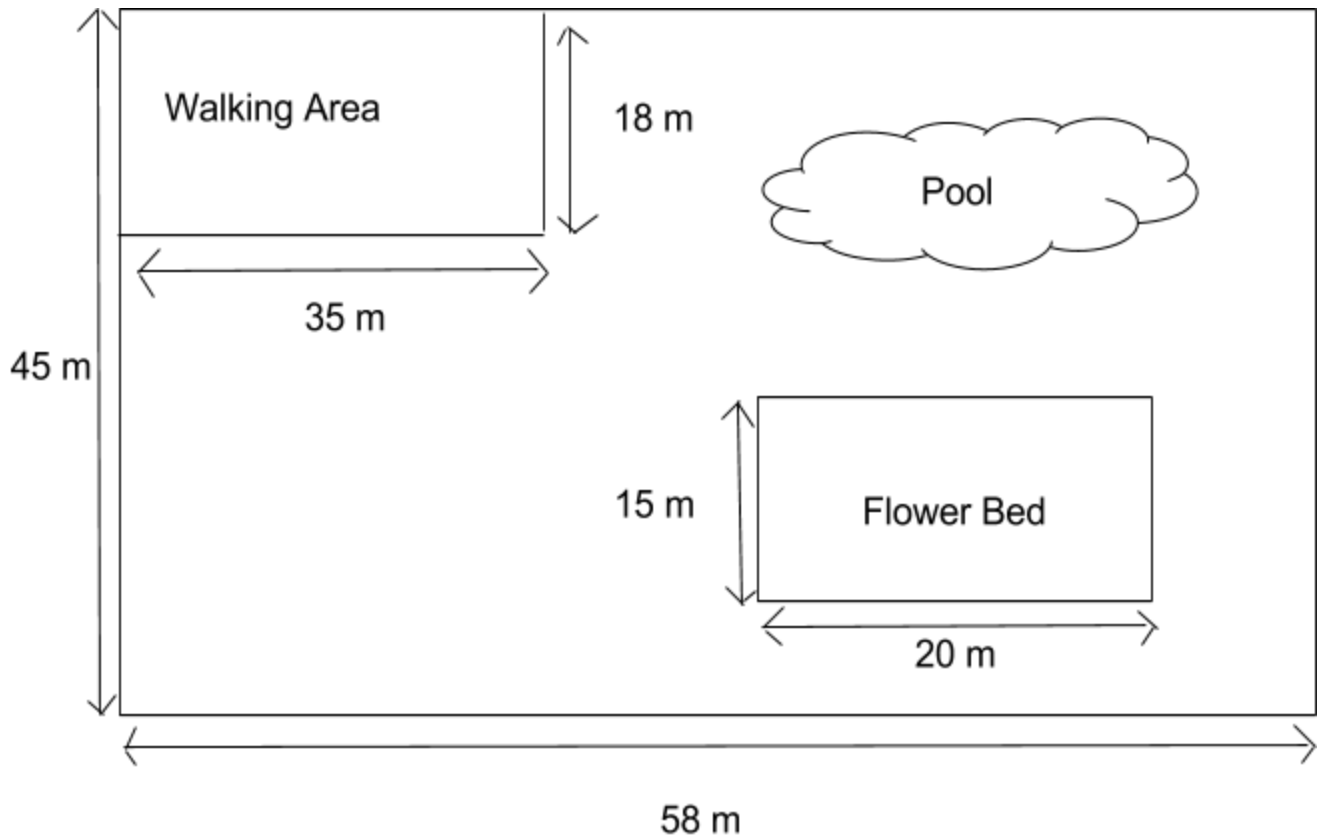

A park is being designed for a new housing society. Help the planners understand the proper division of the park area.

- What is the total area covered by the flower bed and the walking area in the lawn?
- If the dimensions of the flower bed are changed to length 28 m and breadth 17 m, how much more area will the new flower bed occupy?
- Find the area of the park that does not include the walking area.

b) Fill in the blanks:

- Sum of lengths of all sides of a figure is - _____
- Space enclosed by a figure is- _____
- If the perimeter of the square is 64 cm, length of each side is _____
- The measurement of length and breadth is needed to calculate the area of a _____
- Area of the square with length 5 cm is _____
- Perimeter of the square with length 8 cm is _____

c) Answer the questions after reading the situation:

Ria is hosting her younger sister's birthday party. She has been put in charge of distributing the food items to all the guests. How will she divide these food items? Express the answer as a fraction.

- 20 cookies among 16 guests ____
- A cake among 20 guests ____
- 8 packets of chips among 16 guests ____
- 18 packs of juice among 18 guests ____

d) Simplify the following fractions to their most reduced form:

- $\frac{24}{36}$
- $\frac{4}{10}$
- $\frac{48}{54}$
- $\frac{35}{50}$